

# FireCR flash

## User Guide

### *Veterinary Dental Cassette Kit*

Doc No. : TM-415-EN

Rev 1.0.0 May 2016

Part No. : CR-FPM-44-015-EN

**3DISC, FireCR, Quantor** and the **3D Cube** are trademarks of **3D Imaging & Simulations Corp.**, South Korea, and its affiliates. All other trademarks are held by their respective owners and are used in an editorial fashion with no intention of infringement. The data in this publication are for illustration purposes only and do not necessarily represent standards or specifications, which must be met by **3D Imaging & Simulations Corp.** All information contained herein is intended for guidance purposes only, and characteristics of the products and services described in this publication can be changed at any time without notice. Products and services may not be available in your local area. Please contact your local sales representative for availability information. **3D Imaging & Simulations Corp.** strives to provide as accurate information as possible, but shall not be responsible for any typographical error.

© Copyright 2016 **3D Imaging & Simulations Corp.** All rights reserved.

**3DISC**  
I M A G I N G

**Contact**

3D Imaging & Simulations Corp.  
Bldg.1, 48, Yuseong-daero 1184 beon-gil,  
Yuseong-gu, Daejeon, 305-345 Korea

Tel : 82-42-931-2100  
Fax : 82-42-931-2299

Website : [www.3DISCimaging.com](http://www.3DISCimaging.com)  
E-mail : [info@3DISCimaging.com](mailto:info@3DISCimaging.com)

3DISC Americas  
22560 Glenn Dr, Suite 116  
Sterling, VA 20164 USA  
Tel : 1-703-430-6080  
E-mail : [info@3DISCimaging.com](mailto:info@3DISCimaging.com)



3DISC Europe  
Gydevang, 39-41, 3450 Alleroed, Denmark  
Tel : 45-88-276-650  
E-mail : [info@3DISCimaging.com](mailto:info@3DISCimaging.com)

## Warnings and Used Symbols

To ensure the safety of patients, staff and other persons, any changes to software and hardware delivered by **3D Imaging & Simulations Corp.** may only be made with prior written permission from **3D Imaging & Simulations Corp.**

Please read the respective manuals of the connected software, such as acquisition and diagnostic software, before starting to use the system.

The following symbols will be used throughout this manual:



### **DANGER**

General prohibition indication.

The functionality of the system can be destroyed in the case of incorrect use.

If unauthorized changes have been made to delivered system and accessories, the warranty by **3D Imaging & Simulations Corp.** becomes void. **3D Imaging & Simulations Corp.** will not accept any responsibility or liability for the proper functioning of the product in such a case.



### **DANGER**

General mandatory action manual.

The functionality of the system can be destroyed in the case of incorrect use.

If unauthorized changes have been made to delivered system and accessories, the warranty by **3D Imaging & Simulations Corp.** becomes void. **3D Imaging & Simulations Corp.** will not accept any responsibility or liability for the improper functioning of the product in such a case.



### **WARNING**

The functionality of the system can be limited in the case of incorrect use. Hints that require special attention.



### **NOTE**

Notes represent information that is important to know but which do not affect the functionality of the system.

## 1. *Veterinary Dental Cassette*

Supporting multi imaging plates on a moving plate.

- ✓ Veterinary Dental Cassette
  - Imaging plate size : Each of imaging plate size is marked on the moving plate
    - (1) Size 0 (22 x 31mm) - 2ea,
    - (2) Size 1 (24 x 40mm) - 2ea,
    - (3) Size 2 (31 x 41mm) - 2ea,
    - (4) Size 3 (27 x 54mm) - 2ea
    - (5) Size 4c (48 x 54mm) - 2ea,
    - (6) Size 4 (76 x 57mm) - 2ea



Veterinary Dental Cassette

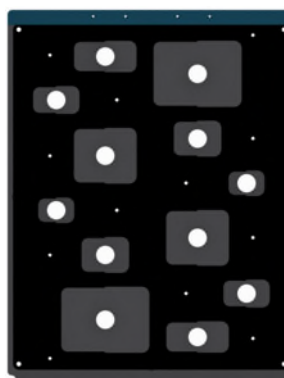

Moving Plate

## 2. Imaging Plate Cleaning

- ✓ Protect your investment

Dust and dirt are piled up on CR imaging plate, leading to image artifacts. To avoid contamination, plates need cleaning at regular intervals.



### **WARNING**

As CR imaging plates are highly sensitive to water based cleaning fluids, we strongly recommend an ethanol-based plate cleaner.

If possible, use a cleaner that is specially designed for CR imaging plates. This will help to ensure the longest possible service life.

### 2.1. Service Life

Imaging plates in the following condition cannot be used.

- ✓ Scratches on the surface of the protective layer and they appear on the image.
- ✓ The phosphor layer has peeled away from the support layer.

### 2.2. Imaging Plate Cleaning Process

- ✓ Using the dry cleaning cloths listed previously, clean the imaging plate surface as illustrated below.

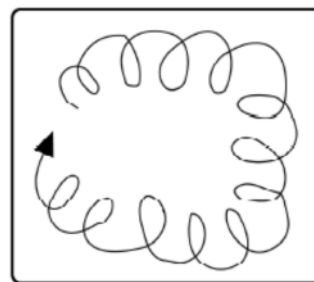
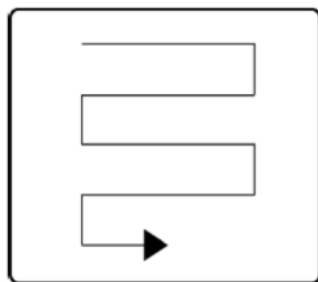

- ✓ Use ethanol based cleaner : ethanol > 99.5%
- ✓ Use ethanol dampened cleaning cloths to clean stains that do not come off with the above method.
- ✓ When the imaging plate surface has been cleaned using ethanol dampened cloth, slightly wipe it off with the listed dry cloths.

**WARNING**

Do not pour ethanol directly on to the imaging plate.  
Make sure the imaging plate surface is completely dry before using the imaging plate.

**WARNING**

Be sure not to damage the imaging plate.  
Do not scratch the imaging plate with your fingernails.  
Never use erasures or any other solvents.  
Never use hand lotions or sunblock cosmetics prior to handling the imaging plate.  
Do not bend or crack the imaging plate during use or cleaning.  
Do not stack other objects on the image plate.  
Do not let the imaging plate stand under direct rays (ultraviolet rays).

**WARNING**

Imaging plates must be discarded according to laws and regulations applicable in each country.

### 3. *Veterinary Dental Cassette Handling*

#### 3.1. *Moving Plate Handling*

##### 3.1.1. *Moving Plate Pull Out*

Pull out the moving plate from the cassette using an extractor.

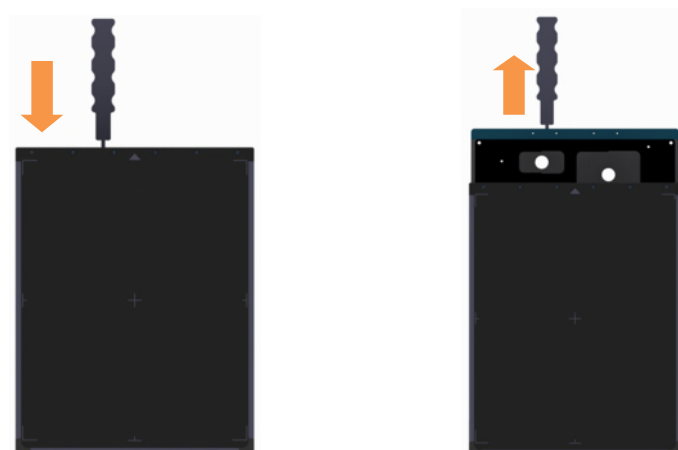

Hook and pull the moving plate out.

##### 3.1.2. *Insert Moving Plate*

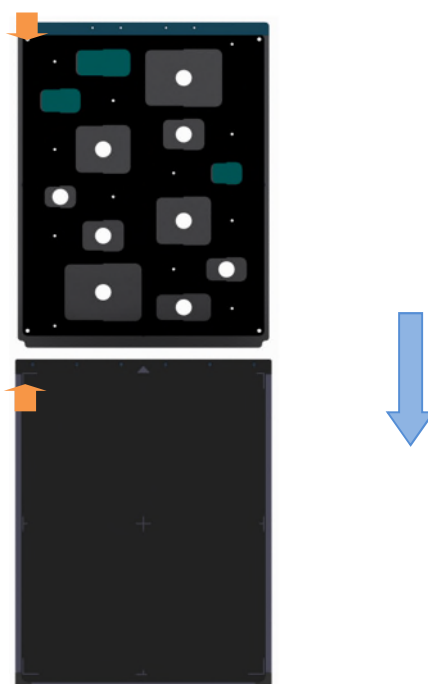

- ✓ Insert moving plate into the cassette gently.

**WARNING**

Do not insert the moving plate in wrong direction.  
Do not lean the moving plate when it is inserted, the imaging plate can be scratched by the cassette.

## 3.2. Imaging Plate Handling

### 3.2.1. Placing Imaging Plate on the Moving Plate

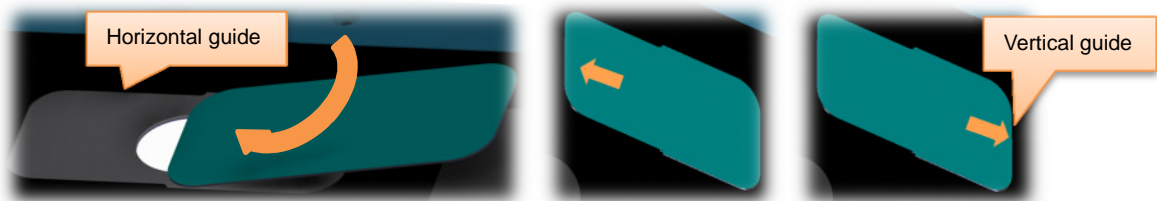

- ✓ Slide IP follow the Horizontal guides to the end.
- ✓ Put back to the IP under the Vertical guide.

**WARNING**

Do not put the imaging plate upside down when it is inserted.

### 3.2.2. Removing Imaging Plate from the Moving Plate



- ✓ Remove IP from the Vertical guide.
- ✓ Push imaging plate from the backside of moving plat
- ✓ Slide up IP from the Moving plate.





**DANGER**

Always carry the cassette with the slot side up.

